

P280 Structural Glazing System

July 2011

Standard System

Reference:	P280
Colour:	Mill, White or Brown
Length:	3 metres, 4 metre and 6 metres
Span:	3.2 metres

Description:

An aluminium structural glazing system into which multiwall polycarbonate or glass can be fitted. When glazing with multiwall polycarbonate the P280 system is capable of spanning up to 3.2 metres between fixing points*. For applications longer than 3.2 metres span, an intermediate cross purlin should be installed to create a further fixing point, alternatively use the P288 system which can span up to 4 metres.

The P280 system consists of an aluminium base bar (ref.283) and a shaped aluminium glazing bar cap (ref.280), gaskets and an end plate (ref.280EP).

The base bar is fitted to the ridge and eaves support, the glazing sheet sits on the gasket and the cap is drilled at intervals no more than 400mm apart. Screws are then fitted through the cap into the central stalk of the base bar. The length of screw differs with each thickness of glazing sheet. A screw cover cap is needed to cover and protect the head of the screw.

For applications without good ventilation i.e. enclosed sides, it is recommended that a uPVC thermal underclad be supplied to clip onto the base bar to minimise the risk of condensation forming. Please ask for details of this system, reference P284 system.

The P280 system is supplied as a pre-pack in 3 metre and 4 metre lengths with gaskets installed and as loose items in 6 metres.

Hip System

Reference:	P280H
Colour:	Mill Finish, White or Brown
Length:	3 metre and 4 metre (and 6 metres as non-standard)

To make the bar suitable for a hipped application, the gasket in the glazing bar cap and base is replaced by a half-round gasket and re-named as P280H. The P280H is supplied as a pre-pack in 3 metre and 4 metre lengths and as loose items in 6 metres. The 3 metre and 4 metre pre-pack consists of the aluminium glazing bar cap and base, hipped gasket and a screw fit end plate.

Applications:

- | | | |
|------------------------|-------------------------|------------------|
| • Medium Span Roofing | • Rooflights | • Conservatories |
| • Cross Purlin Roofing | • Swimming Pool Covers | • Car Ports |
| • Canopies | • Garden Centre Roofing | • Porches |

* **NOTE:** When glazed at maximum recommended polycarbonate glazing centres, i.e.:

10mm sheet	=	700 mm
16mm sheet	=	990mm
25mm sheet	=	1250mm

Glazing with Glass

The P280 system is suitable for use with glass. However, we cannot advise the spanning capability of the system or at what centres the glazing bars should be placed. We do, however, recommend that a mechanically fixed end plate similar to our SB-MEP end plate be fitted at the end of each bar to stop the glass from slipping.



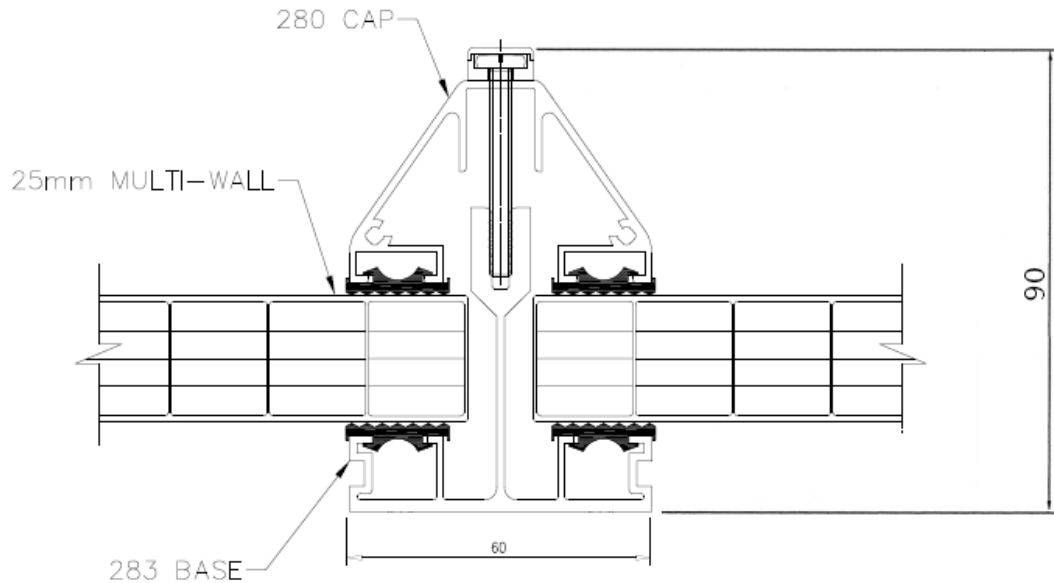

The P280 structural glazing bar system can be used to install multiwall polycarbonate, solid polycarbonate or glass in thickness ranging from 4mm to 25mm. The P280 can be supplied either as a pre-pack complete with the aluminium base bar and bar cap, both with gasket fitted and an end plate or as loose individual items. The P280 system can also be supplied as a hipped system which uses the same cap. With this system we change the standard gasket to a half round gasket which allows the sheet to be fitted at an angle.

Pack lengths available:

3 metres, 4 metres

Pack contents:

280 aluminium bar cap with gasket fitted
283 aluminium base bar with gasket fitted
280EP end plate



Loose item lengths available:

6 metres

Colours available:

Mill, or powder coated white or brown
RAL or BS colours to special order

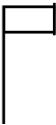
Complementary Fixing Accessories for use with the P280 structural glazing bar system:

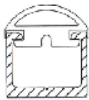
Side Trim Ref 272 – 10mm Ref 273 – 16mm Ref 275 – 25mm		U Profile Ref 252 – 10mm Ref 253 – 16mm Ref 255 – 25mm	
Eaves Filler Ref 285F		Fixing Buttons (white) Ref244P – 10mm Ref245P – 16mm Ref249P – 25mm	Fixing Buttons (Brown) Ref247P – 10mm Ref248P – 16mm Ref250P – 25mm
Anti-dust/Breather Tape Ref FT or PBT 10 Ref FT or PBT 16 Ref FT or PBT 25	Butyl Flashing 200/20 White 200/20 Lead		